

# AI Precision Sensor

## PC8-A

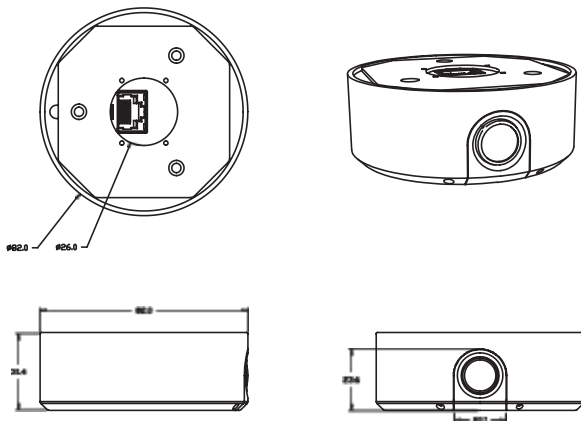

### Product Size



Unit: mm

### Product Features

200 Megapixel, Support POE

Support for Clientele Group Analysis, Local device  
De-duplication

Data Security, Close-Loop Local Detection and  
Comparison Process

Compact size, Support Ceiling installation

### Technical Parameters

#### Accurate People Counter

Sensor	200 Megapixel 1/2.8" Progressive Scan
	Image Sensor
Lens	12mm Fixed focus F=1.6 FOV-H: 33° , Optional Lens: 6、8、16mm
Min. Illumination	Color : 0.002Lux @(F1.6, AGC ON)
Shutter	1-1/30000s
Signal to Noise Ratio	≥ 57 dB
White Balance	Automate
Gain Control	Automate
DNR	3 D- DNR
WDR	Support

#### Video

Coding Format	H.264 Base Line Profile / Main Profile / High Profile
Resolution	1920 × 1080
Video Frame Rate	1~25fps
Video Bitrate	64 Kbps~16 Mbps
Muti-Stream	Dual Stream
Subtitle	Time, Date, Subtitles Display, Support Configuration
Image configuration	Configurable Brightness, Contrast, Saturation, Sharpness, Mirroring

#### Network

Network Protocol	TCP/IP, ICMP, HTTP, DHCP, RTSP
------------------	--------------------------------

#### System

System Recovery	Support
Heartbeat Function	Support
Security	Multi-level user management with password protection

#### People Counting

Accuracy	≥95% (Test Environment)
Library Storage	30,000 Pics
Detection Density	30 Pics

#### External Interface

Network Interface	1 × RJ45, 10Base-T/100Base-TX, POE
Power	Non

#### Environment

Temperature	-25°C~55°C
Humidity	10%~85% (No Condensation)
Power Supply	POE
Wastage	≤ 5 W

#### Physical

Weight	Device≤0.15kg, With Packing≤0.4kg
Dimensions	Diameter 82 x 31.4 mm
Installation	Ceiling Installation